



SHARK

281 NC 5.0

Shark 281 NC 5.0, electrohydraulic automatic band sawing machine which can operate also in semi-automatic, semi-automatic/dynamic and manual mode to cut from 0° to +60°.

- Cnc machine with windows base MEP50 control. This plc has been specifically designed by mep for the automation of its products range.

FEATURES:

- 7" touch screen display operator interface and push buttons for all functions of the sawing machine. It is simple and user friendly showing all the cutting parameters in real time.

- Programmable plc up to 100 different jobs which can be made in sequence.



OPTIONALS FROM PAG 47 - N° 02 - 03 - 04 - 10 - 11 - 14 - 15 - 17 - 33 - 34 - 49 - 57 - 58 - 60 - 72 - 73 - 80

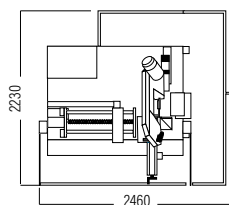
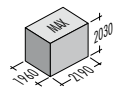

mm	kW	m/min	mm	0°	250	230	280x200	kg
2950x27x0,9	2,2	15÷100	285	+45°	190	180	180x180	
				+60°	120	110	110x110	1055



- Low voltage control panel installed on an articulated arm.
- Visualization and registration of alarms and events with the possibility to visualize the story of occurred events.
- Electronic inverter for infinite variable band saw blade speed (from 15 to 100m/min).
- Latest generation hydraulic unit, with high efficiency and low energy consumption.
- Upper and lower saw head limits and bar feeder forward/backward, are set through a joystick according to dimension of the material.
- Structure in grey cast iron g25, reducing drastically vibrations, grant a better stability and longer blade life.
- Hydraulic vice sliding sideways when the machine mitre left or right. Fast material approach device.
- Bar feeder with stepper motor and ball screw. Multi-indexing up to 600mm in a single stroke with automatic blade kerf compensation.
- Cutting head and feeding vice positioning with joystick.
- Self regulation in real time of head down feed rate.
- Continuous control of the blade rotation. In case the blade is jammed, automatically the machine will stop.



- Adjustable rollers for bundle cutting on one row.
- Electronic transducer to visualize band tensioning.
- Self regulation in real time of head down feed rate.
- Coolant tank inside the steel base with two electric pumps to lubricate and cool off the band saw blade. The drawer to collect chips can be replaced with a motorized chip evacuator (see optionals).
- Preset to be equipped with the spray mist system (OPTIONAL), as well as with the standard-delivered traditional lubrication with emulsible oil.
- Additional foot pedal with emergency stop (OPTIONAL).
- Wire chip brush for band cleaning.
- Emergency lamp with acoustic signal in case the machine is in a stand still situation.
- Machine arranged for handling with movement equipment.
- Bi-metal band saw blade for solids and profiles.
- Service keys and instructions manual for maintenance and spare parts list.

